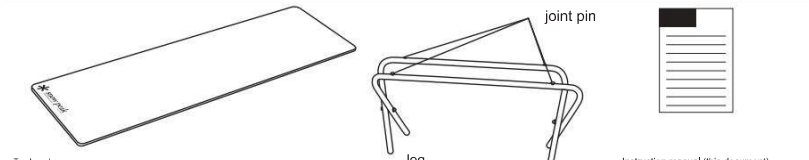

LV-066TR folding shelf long bamboo

Thank you for purchasing a Snow Peak product. This product is an assembly type shelf. For safe use, please read the following instruction manual carefully before use. Also, keep it in a safe place after reading. If you do not understand the contents of the instruction manual or if you find any defects in the product, please stop using it immediately and contact the store where you purchased it or our user service.

Set contents (name of each part)	spec
 <p>Top board</p> <p>joint pin</p> <p>leg</p> <p>Instruction manual (this document)</p>	<p>•Materials: laminated bamboo, aluminum alloy</p> <p>•Size: 1096×340×397(h)mm •Storage size: 1096×470mm •Top plate size: 1096×340mm •Weight: 5.8kg</p>

Safety Precautions Please read carefully before use to avoid possible accidents and use safely.

⚠ DANGER Indicates an action that is clearly expected to result in a serious life-threatening accident.

•Keep it away from fire, flames and combustors. •Do not let infants or small children sleep or sit on this product alone. Parents should always supervise children when using.

⚠ WARNING Indicates that incorrect handling may result in death or serious injury to the user.

•Carefully read the instruction manual for each product used in combination with this product before use. •Do not move the product with objects on it. Doing so may damage the product or cause injury. •Never modify the product. loss of function or loss of strength. We cannot accept after-sales service for modified products. •Before using, make sure that the legs are securely set on the top plate. If it is not securely set, the joint may be damaged or the top plate may fall off during use, which is very dangerous.

⚠ CAUTION Indicates an action that causes extensive damage as injury, damage to the product, or damage to property.

•Be careful not to allow foreign matter or dirt to adhere to the joints. Doing so may interfere with assembly. •Please use it in a firm flat place. •If exposed to rain for a long time or in contact with water for a long time, water may permeate the interior of the coating, causing stains, discoloration, warping, etc. •This product is not for permanent installation. Also, in an environment where heavy objects are constantly placed, the top plate may warp. •Do not rub this product with hard or sharp objects. •When placing objects on this product, be careful not to dent or scratch it. •If the coating film is damaged by hitting the product, it will easily absorb moisture and may cause stains, discoloration, or warping. •Depending on usage conditions, the surface of this product may fade or become discolored. Also, if the temperature rises locally, fading or discoloration may progress. •Putting a hot pan on top of this product after it has been lit may cause it to burn. Never put it down. •This product is made by processing and assembling natural bamboo. Color shades and textures are individual characteristics. Enjoy the natural colors and textures. •This product may warp, distort, or crack depending on how it is used and stored. In particular, do not use or store the product in a place where the heat of the heater is directly transmitted, in a place exposed to direct sunlight for a long time, or inside a car in the summer.

How to use *Reverse the assembly procedure for disassembly.

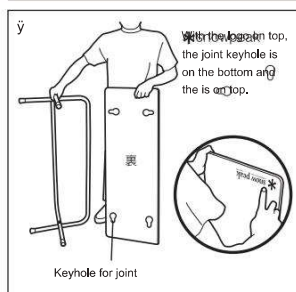

Place the tabletop in front of you with the front side facing you, and hold the top board with the logo is up. (It cannot be assembled in the opposite direction.)

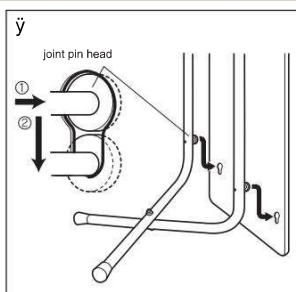

Insert the joint pin heads of the legs into the two keyhole-shaped holes at the bottom of the top plate at the same time. At this time, insert it through the large hole on the top and slide it downward.

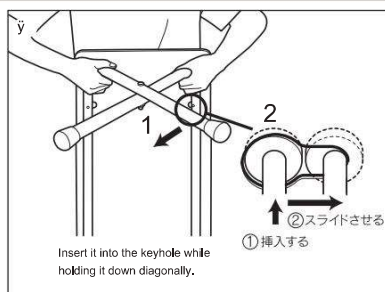

Next, hold the bent portion of the leg and insert one side of the joint pin head into the keyhole-shaped hole. Apply force to the 1 leg in the direction of the arrow and insert the head of the 2 joint pin into the keyhole-shaped hole.

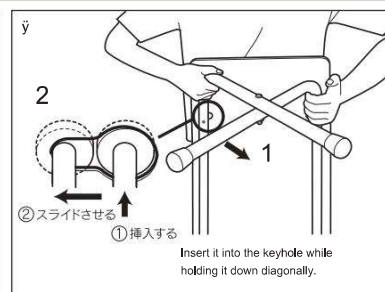

Confirm that the three joint pins are securely inserted, and insert the head of the joint pin into the keyhole-shaped hole in the same way as in ̄. At this time, firmly fix the legs and top plate by hand so that the joint pins inserted in step 3 do not come off.

About maintenance

•If light dirt or moisture adheres to the main unit, immediately wipe it off with a dry cloth and dry it well. •If salt, seasonings, or other chemicals adhere to the product, wipe it off with a tightly wrung cloth and dry it thoroughly. •When storing after use, avoid direct sunlight and store in a well-ventilated place.

About quality assurance

We have made every effort to ensure that the product you have purchased is in perfect condition, but if there are any defects, please contact the store where you purchased the product or our customer service. If it is caused by a manufacturing defect, we will repair or replace it free of charge. In other cases, we will repair it at a reasonable price. We will decide whether to repair or replace the product at our discretion. Also, please note that warranty and repair may not be possible in the following cases.

1. If it is determined that the instruction manual was not followed. 2. Product life due to material deterioration over time. 3. Product failure due to modification and rough handling. 4. Product failure due to unforeseen accidents.

5. Failure of the product due to other defects other than manufacturing defects. 6. Failure due to dust or rust. 7. Occurrence of defects or damage due to disassembly. 8. Defects caused by deformation or breakage of parts due to dropping or other impacts.

9. Deterioration, breakage, failure of consumables and accompanying defects. 10. Failure due to combination with other company's products.

About repair

•If you need a full-scale repair, please contact the store where you purchased the product or our customer service. •When requesting repair, be sure to dry the product thoroughly and remove any dirt. •Be sure to attach a note or tag to the item to be repaired so that the repaired part can be clearly identified. Also, please attach a memo describing the situation at the time of damage in as much detail as possible. •Freight charges for repaired products and repair costs are stipulated as follows. 1. In the case of warranty: We will bear the round-trip transportation and repair costs. 2. If the product is not covered by the warranty: The customer is responsible for the round-trip transportation and repair costs.

不明な点やお気付きの点がございましたら、販売店様または弊社ユーザーサービスまでお問い合わせください。
スノーピークユーザーサービス
0120-010-660
 (9:00~17:00)
 Email: userservice@snowpeak.co.jp

株式会社スノーピーク
 〒955-0147 新潟県三条市中野原456
 Tel. 0256-46-5858 Fax. 0256-46-5860
www.snowpeak.co.jp

Made in China